

# product catalogue

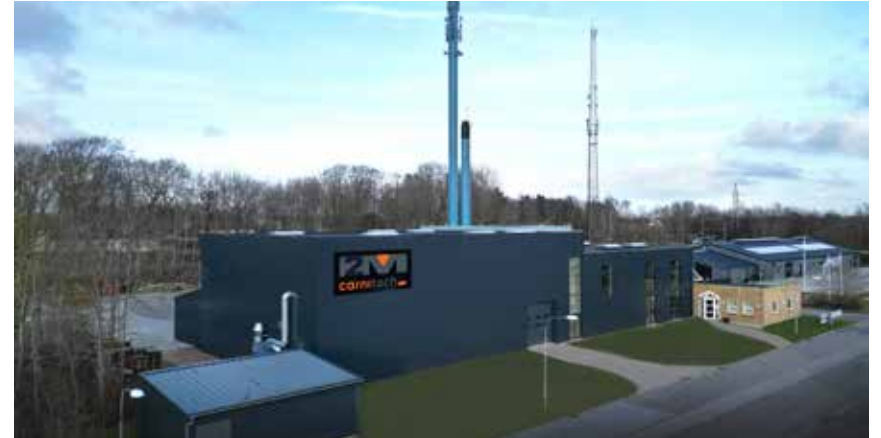

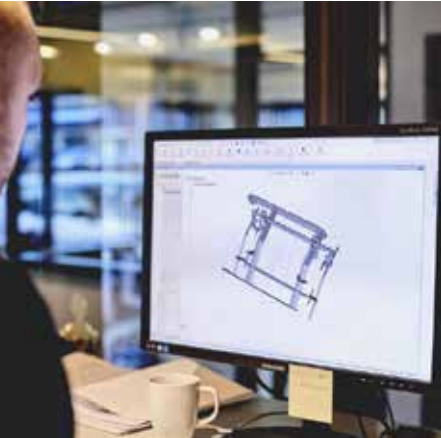

Front view doors closed



Side view doors closed



Side view both doors opened

# 2M Carnitech | Cut up line for pigs

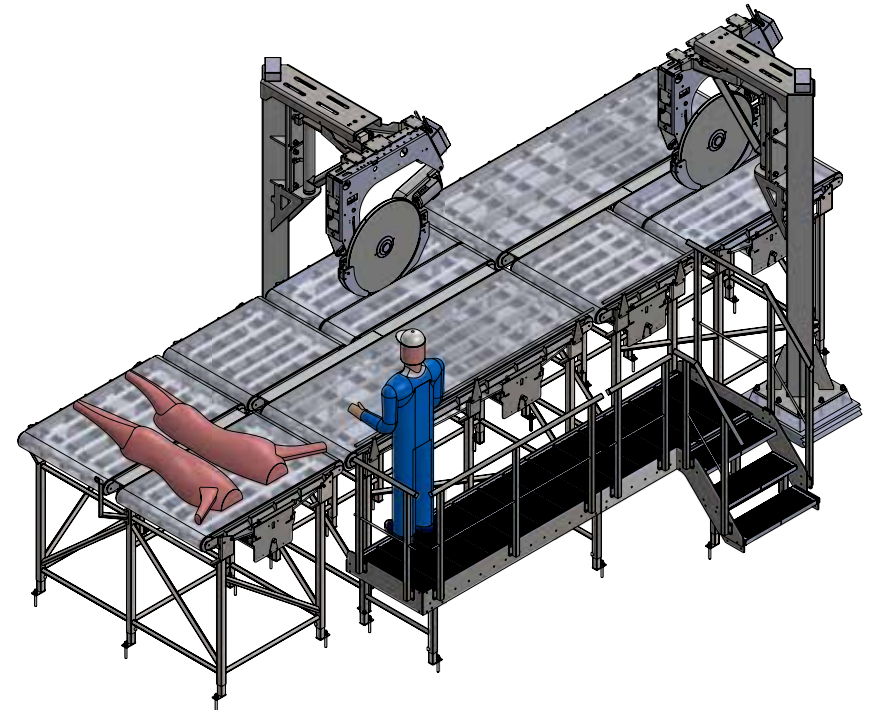
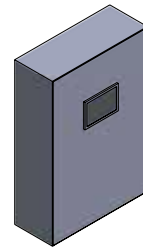
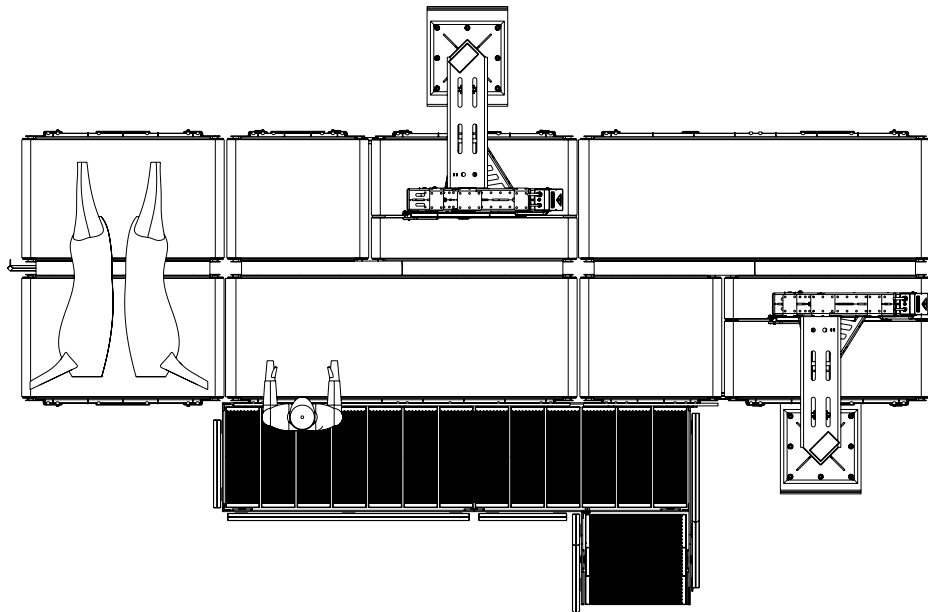
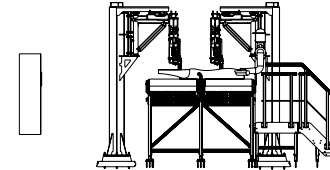
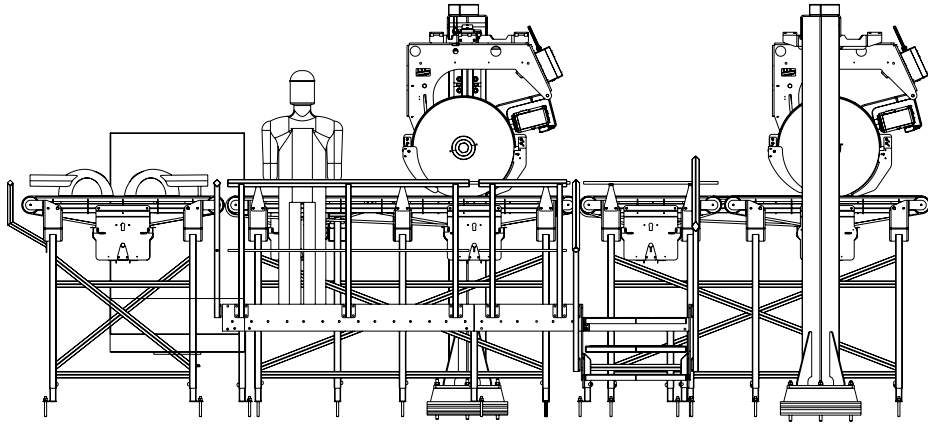

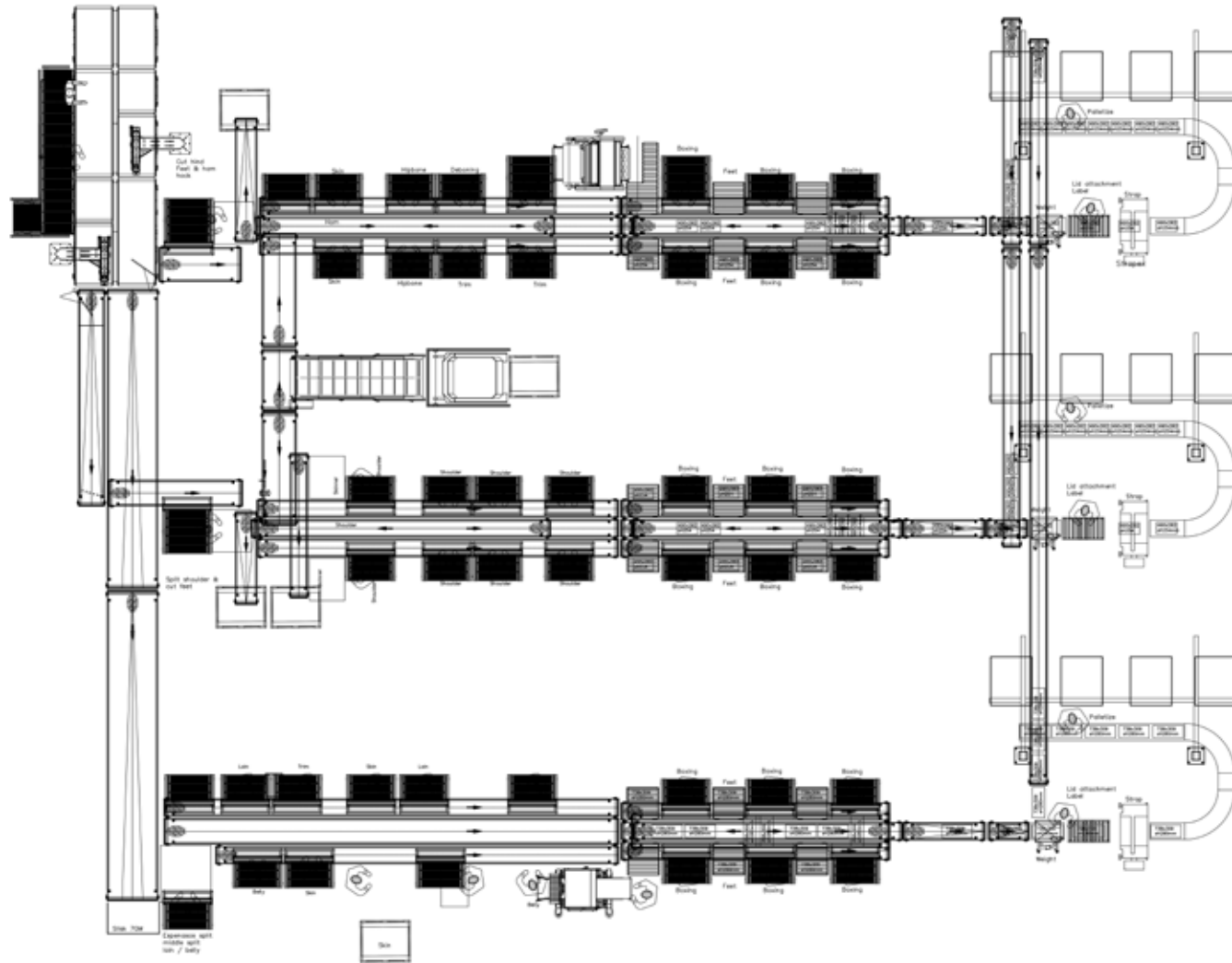
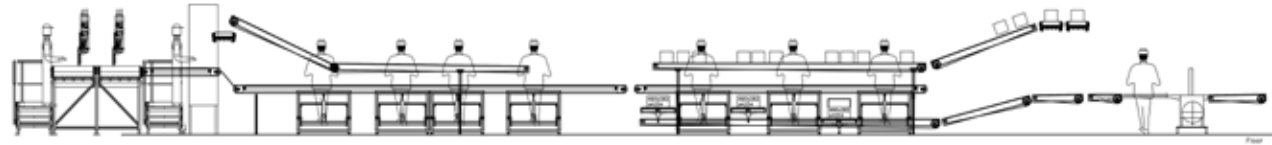

# 2M Carnitech | Curve conveyor for burgers

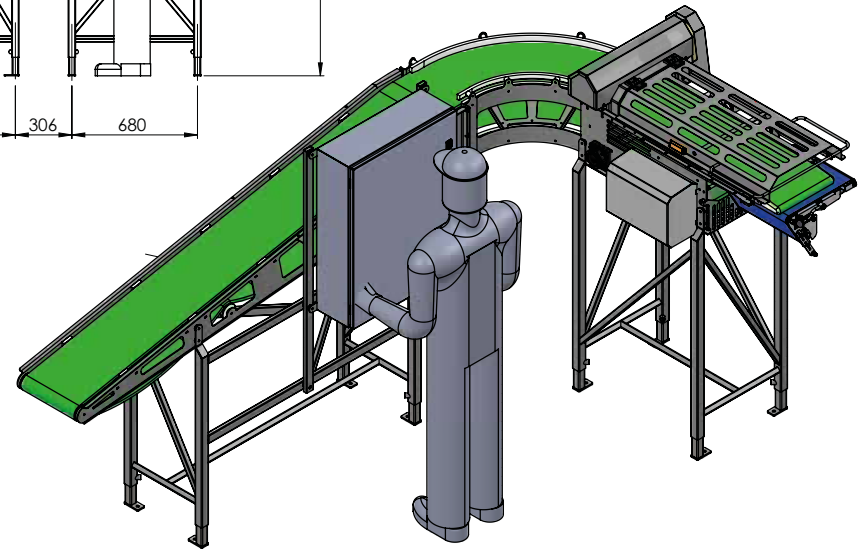
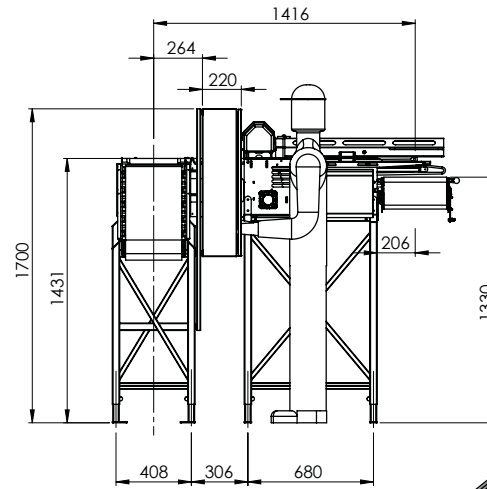
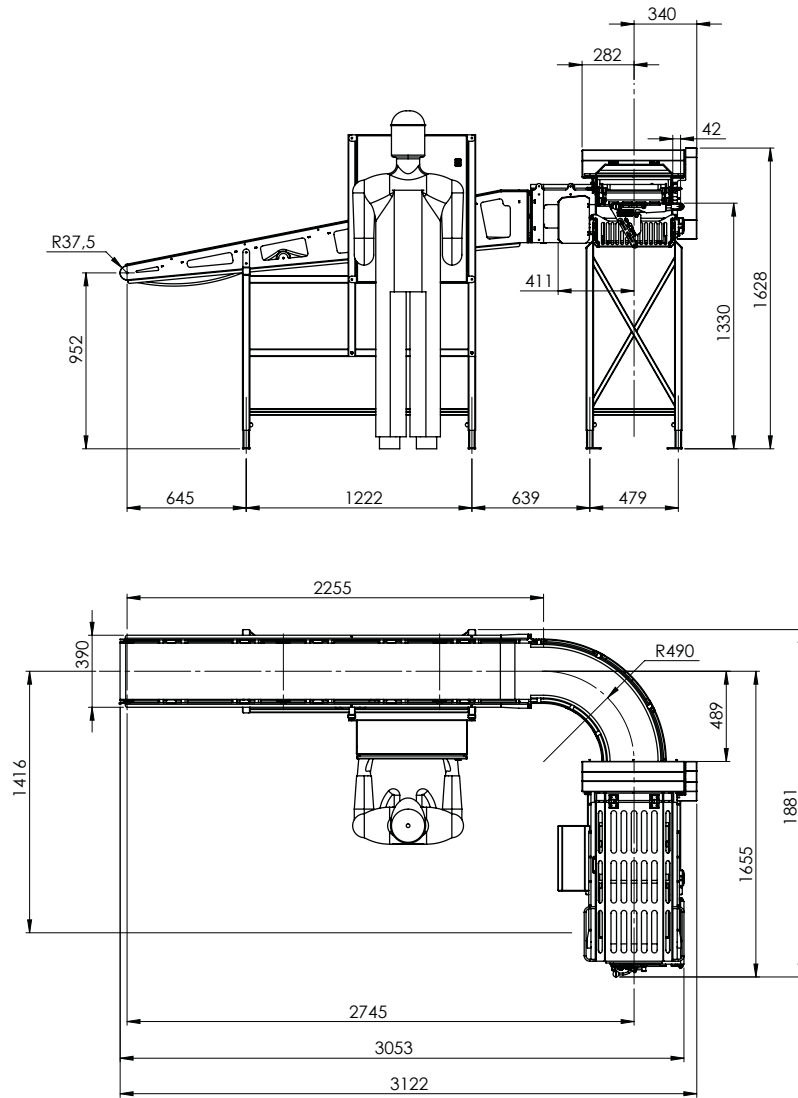

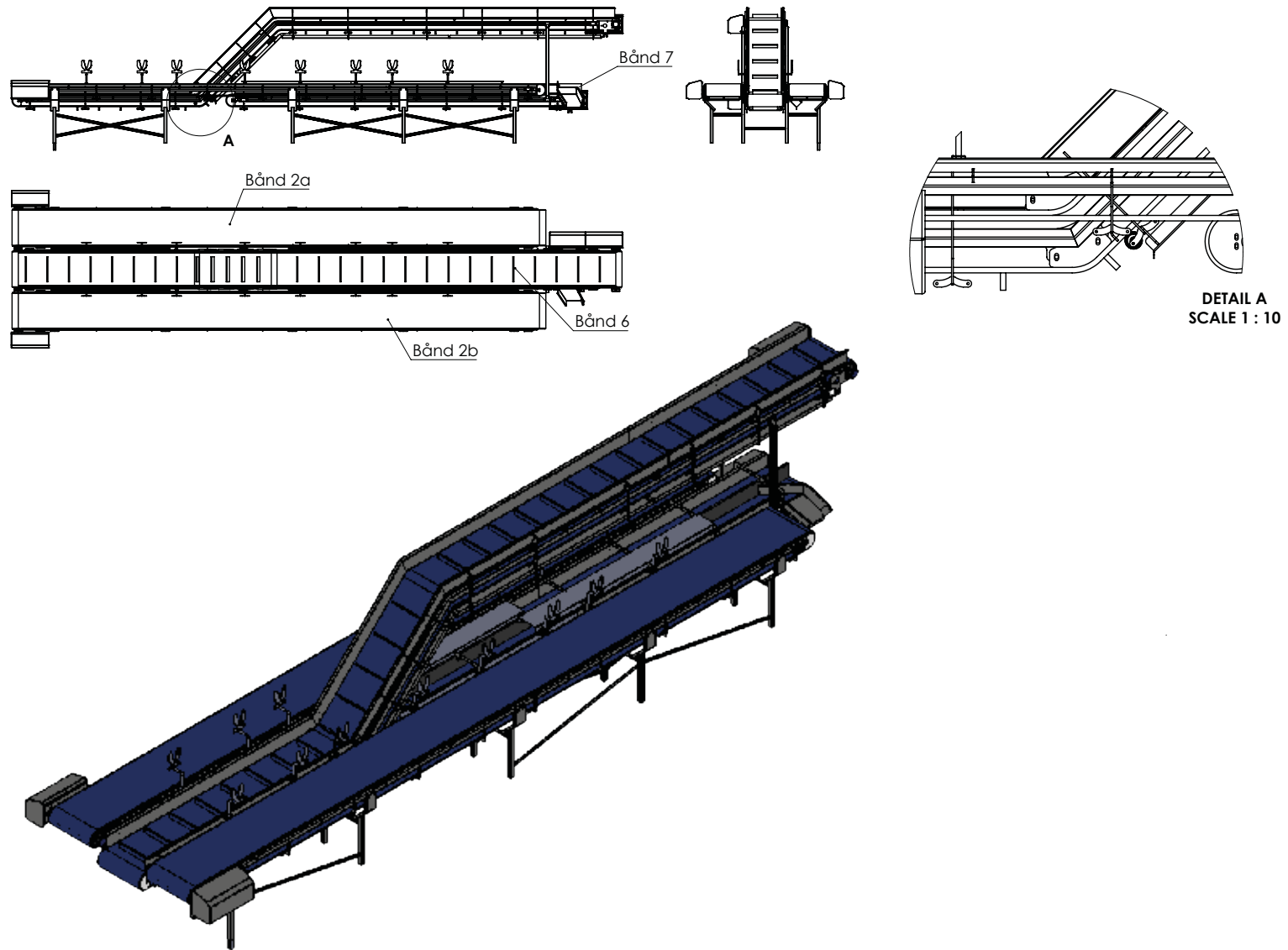

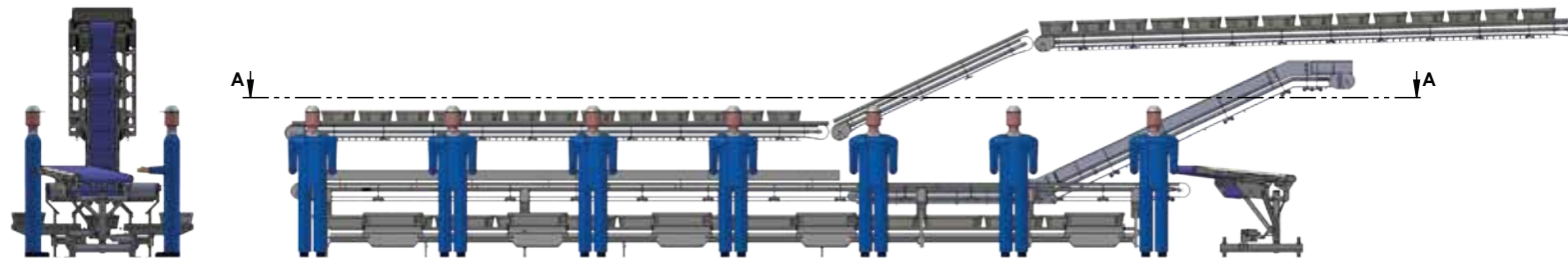

SECTION A-A

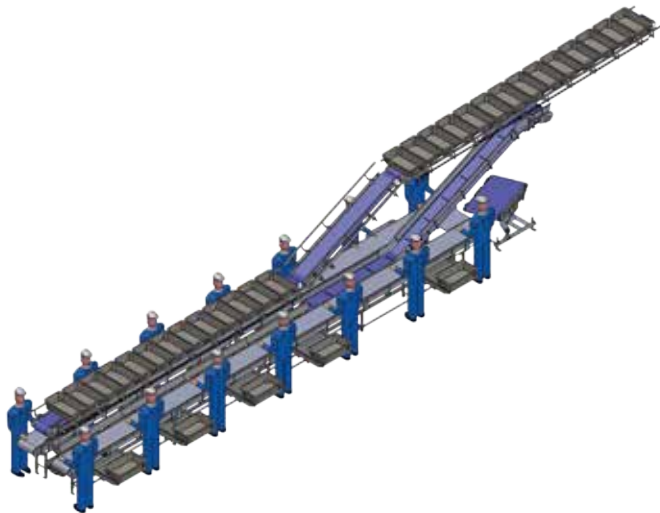
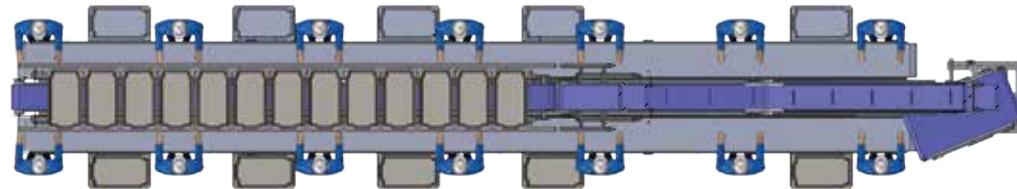

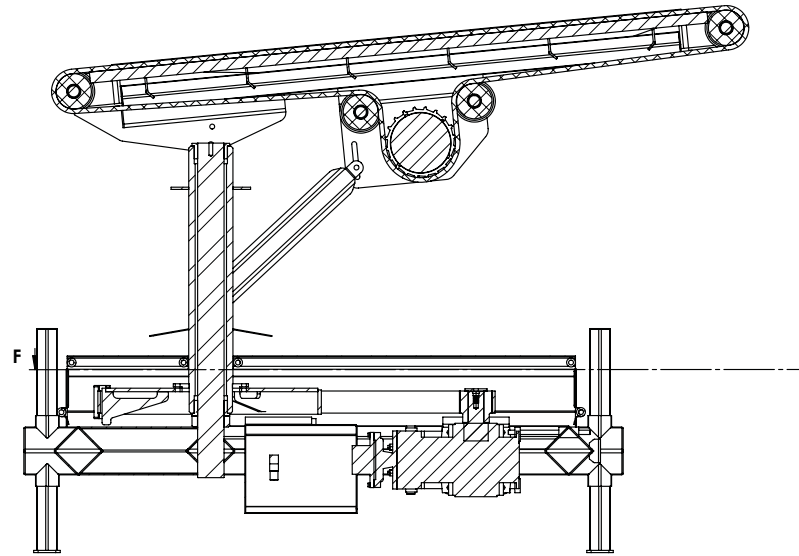

SECTION E-E  
SCALE 1 : 7.5

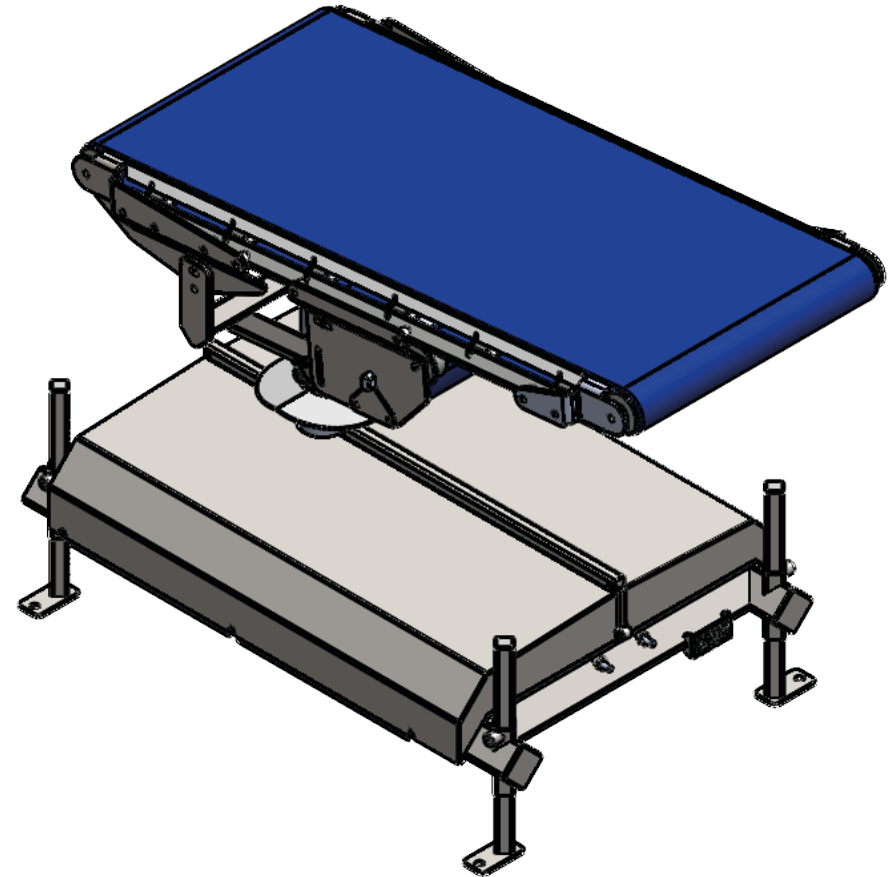
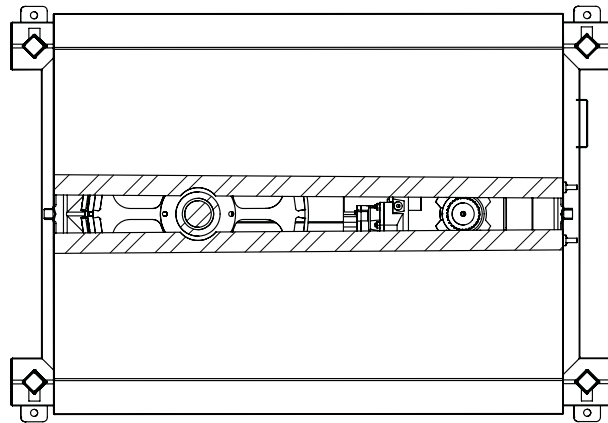



Hydraulically adjustable in stainless steel

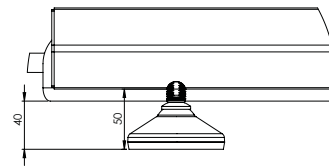
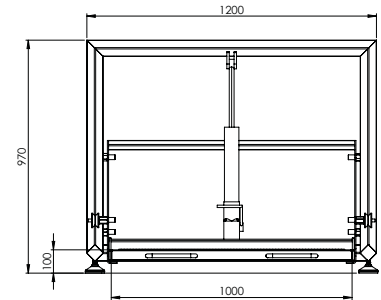
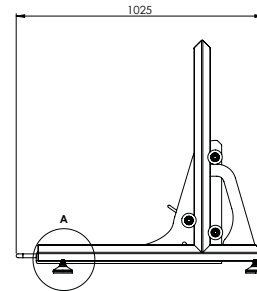
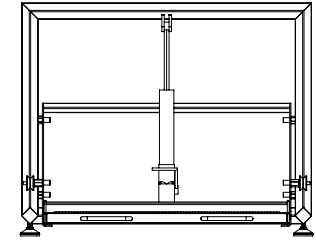
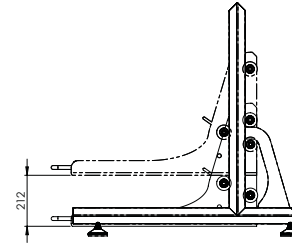
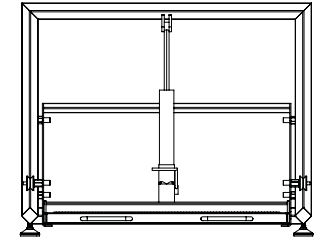
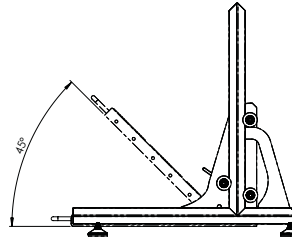

DETAIL A  
SCALE 1:2

Electrical  
adjustable in  
stainless steel

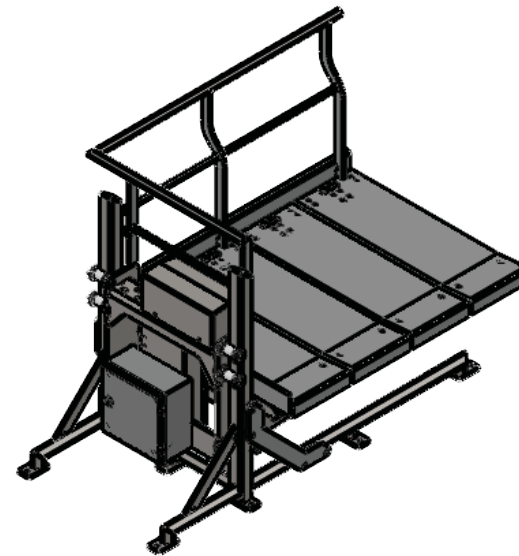
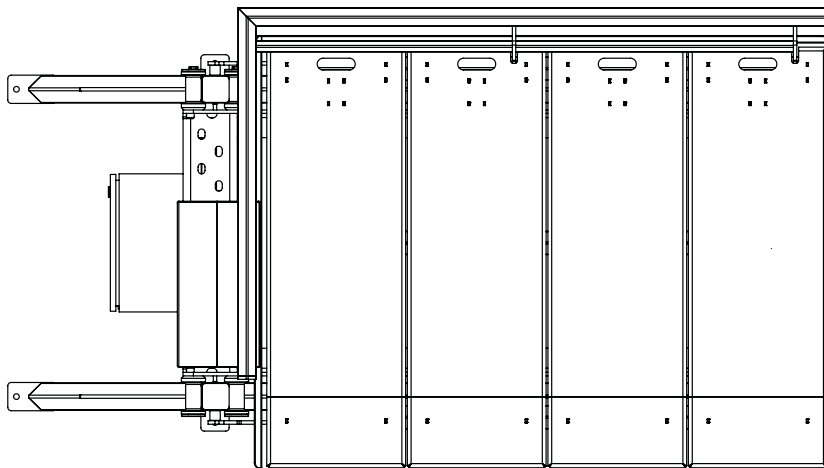
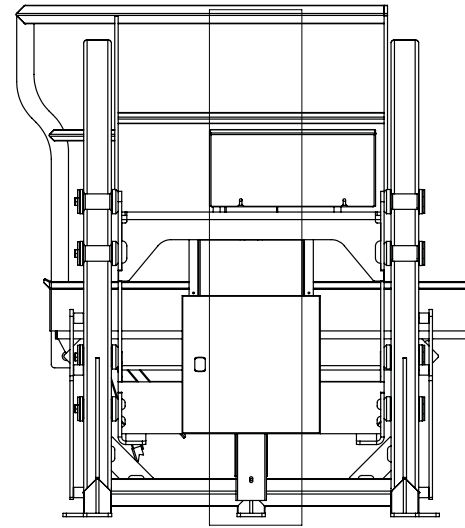
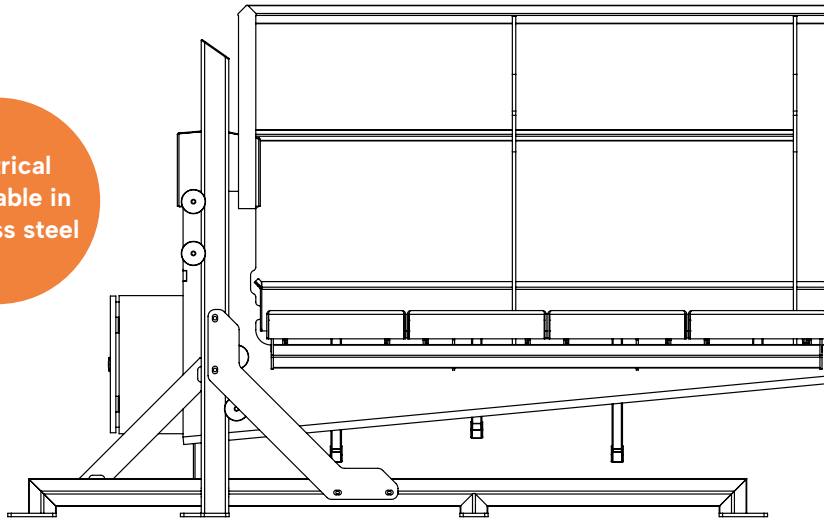

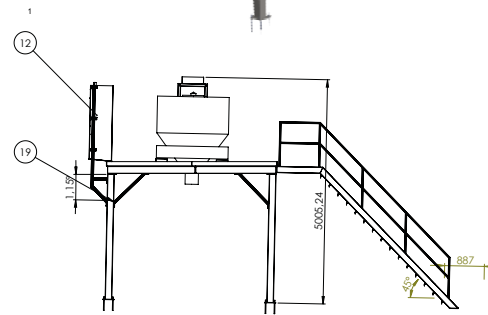
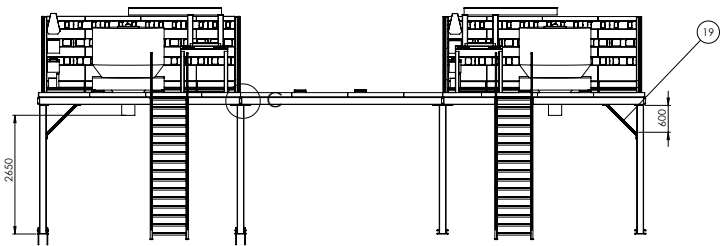
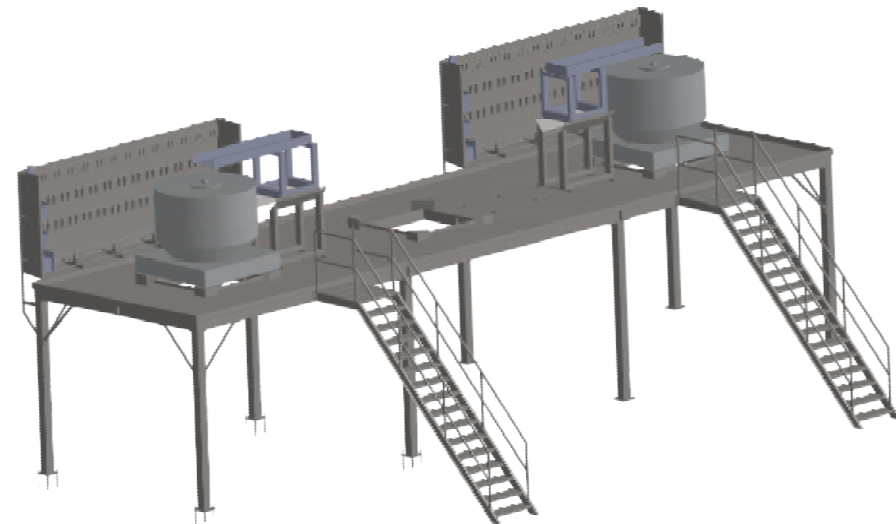
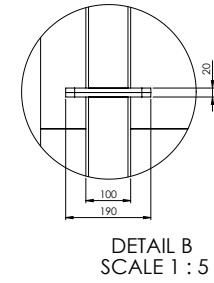
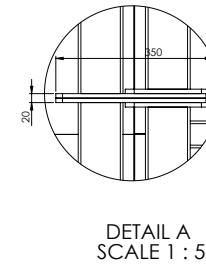
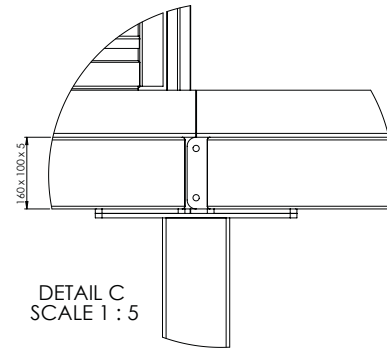
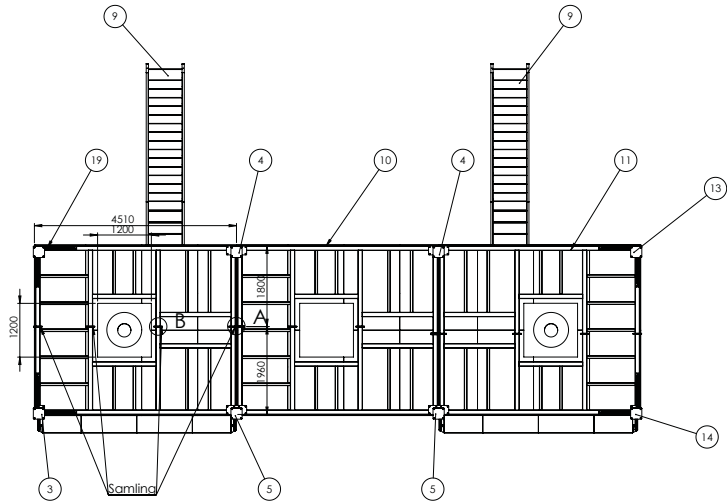

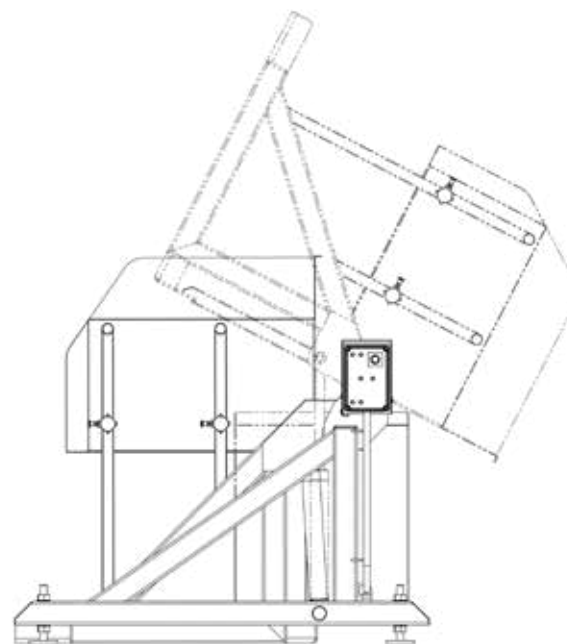
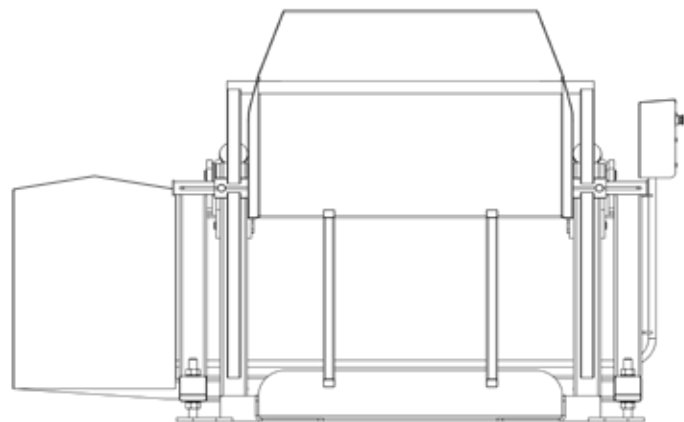

Customized product, not standard

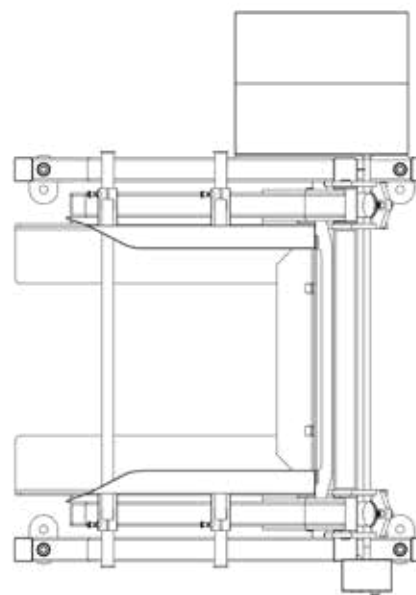
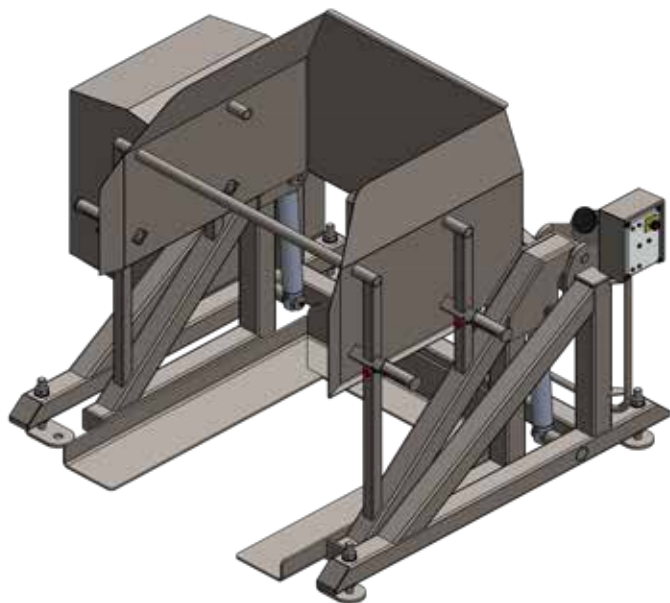

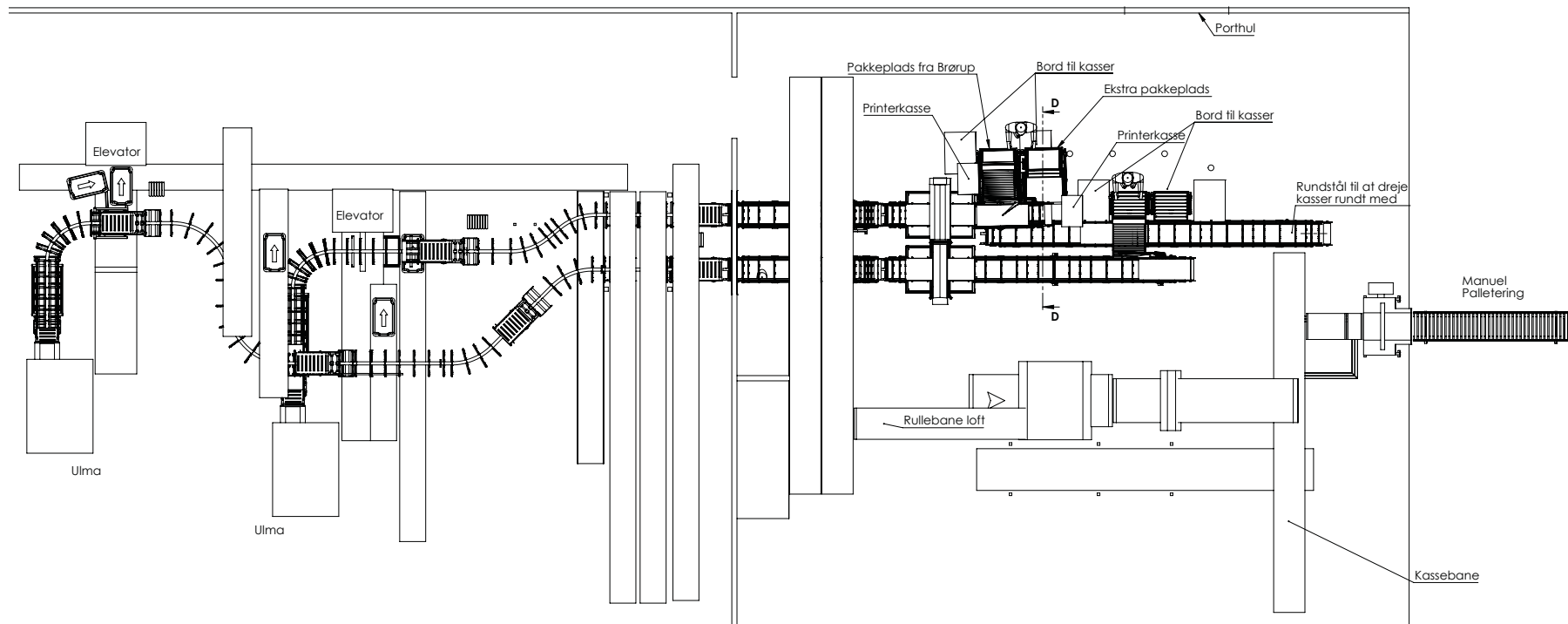
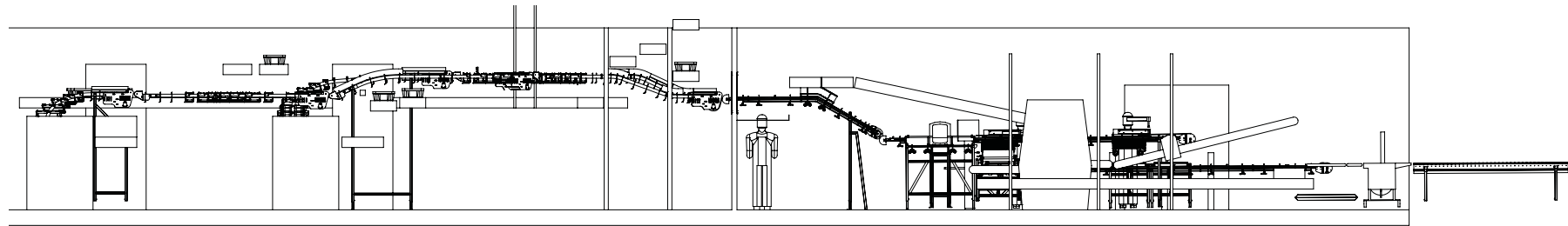

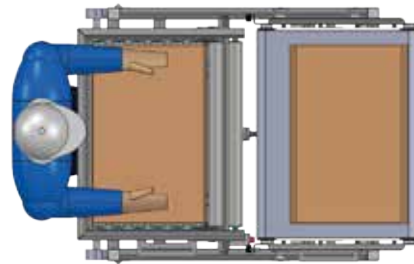
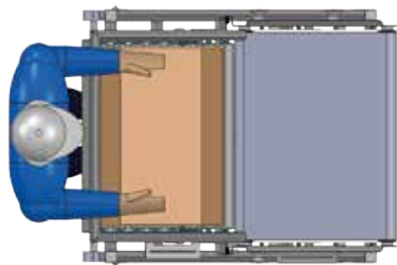
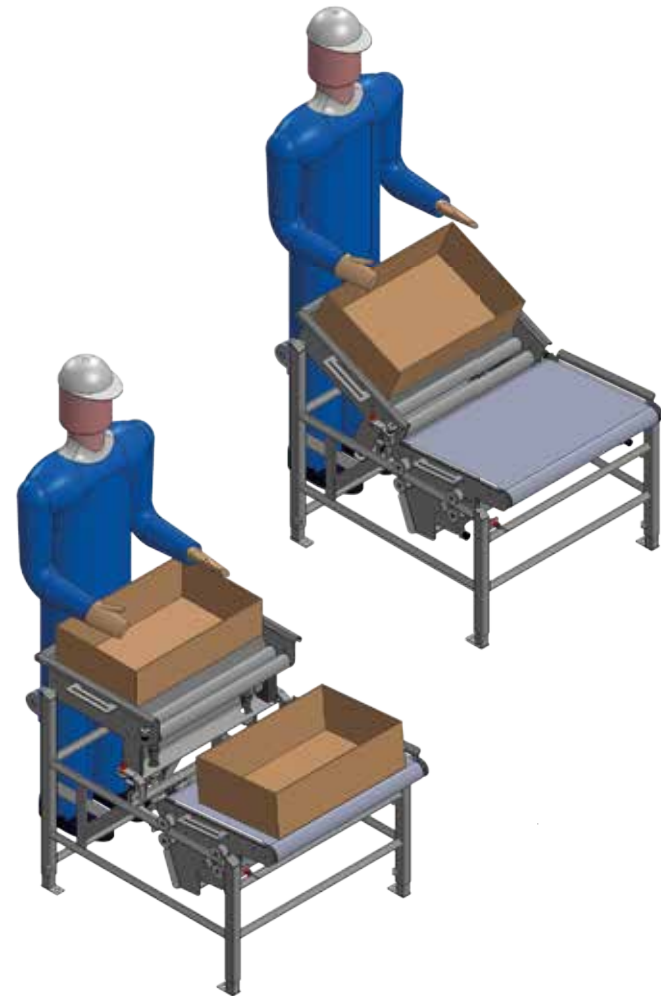
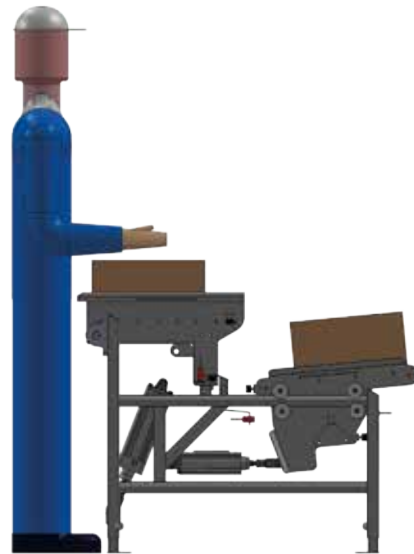

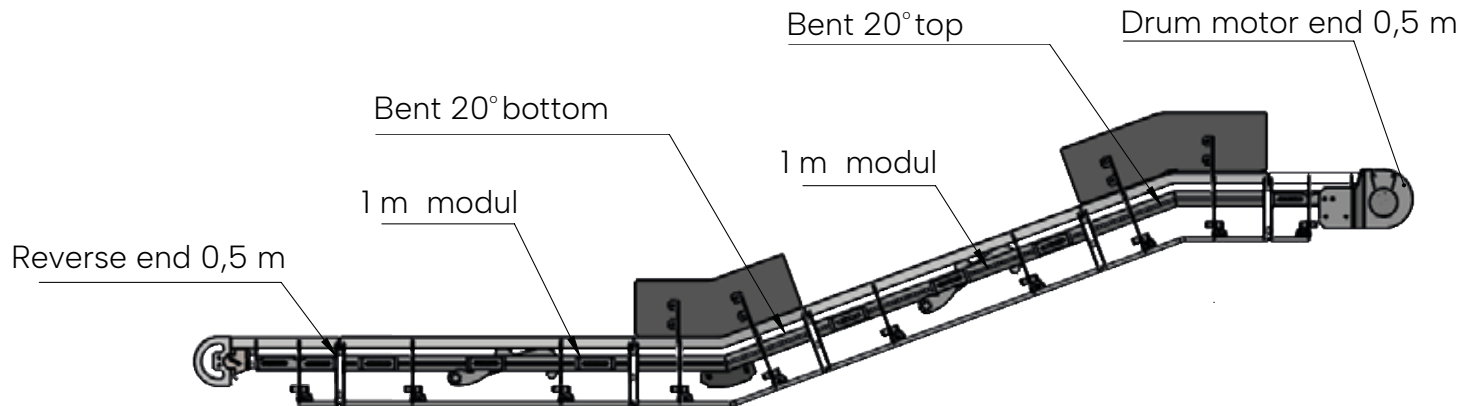
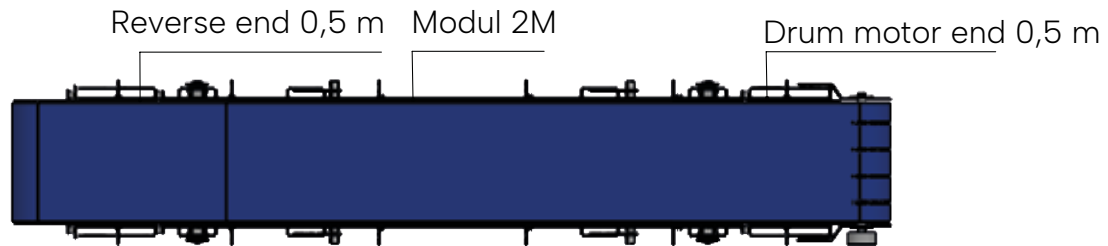

## Ends



Drum motor 0,5m

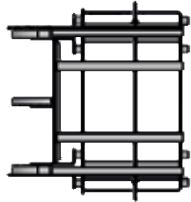

Reverse end 0,5m

## Bents

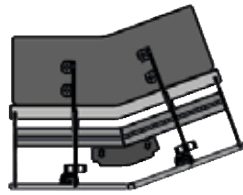

Bent, bottom  
20 deg.  
30 deg.

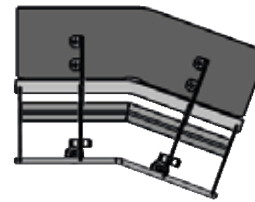

Bent, top  
20 deg.  
30 deg.

## Leg set



## Modules from 1-3 m

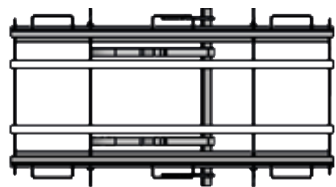

Modul 1m

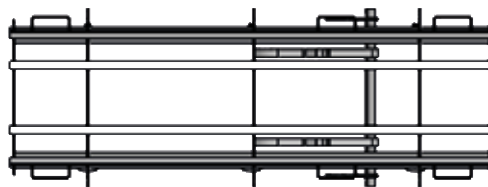

Modul 1,5m

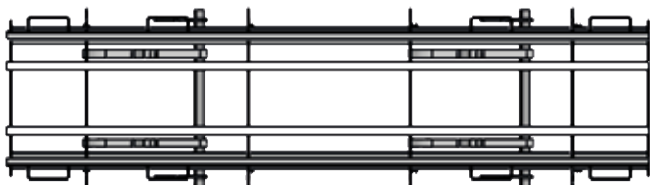

Modul 2m

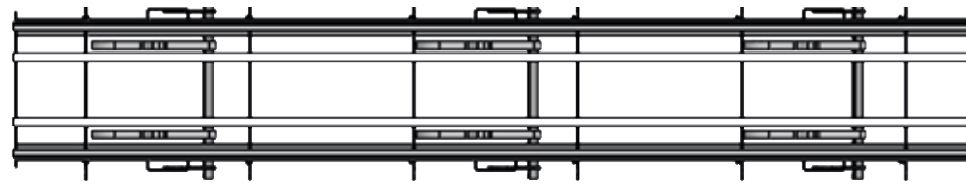

Modul 3m



# 2M Carnitech | Shelves for storage

Complete logistics in stainless steel for storage

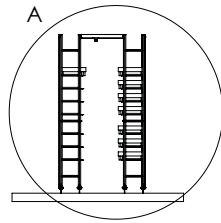

DETAIL E  
SCALE 1 : 10

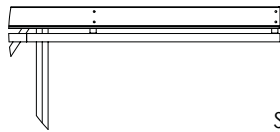
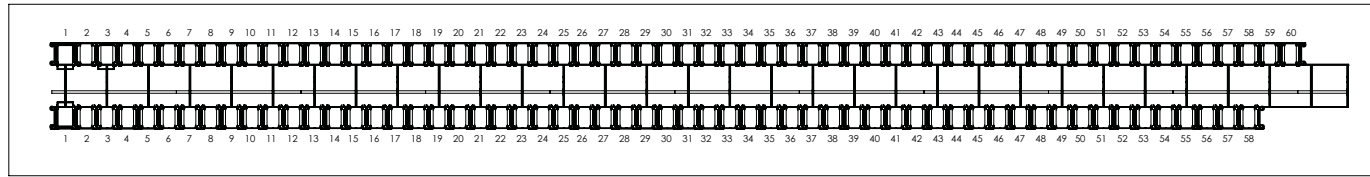
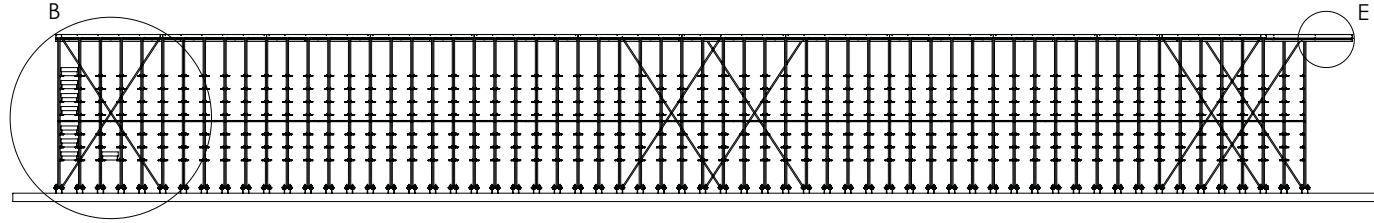

DETAIL A  
SCALE 1 : 20

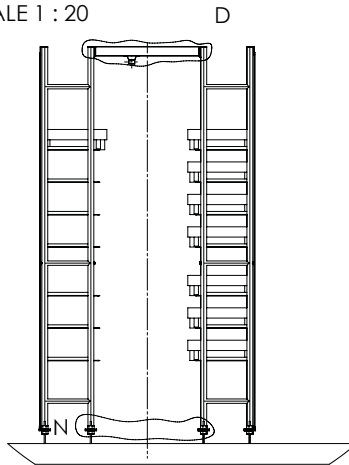

DETAIL N  
SCALE 1 : 5



DETAIL B  
SCALE 1 : 20

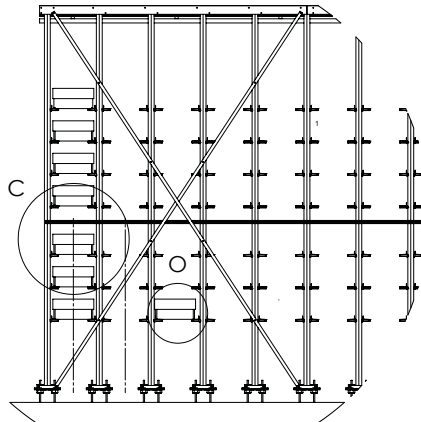

DETAIL D  
SCALE 1 : 5

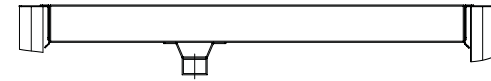

DETAIL C  
SCALE 1 : 10

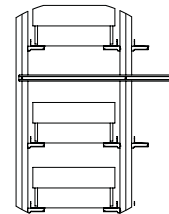

DETAIL O  
SCALE 1 : 5

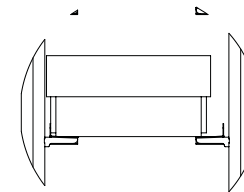

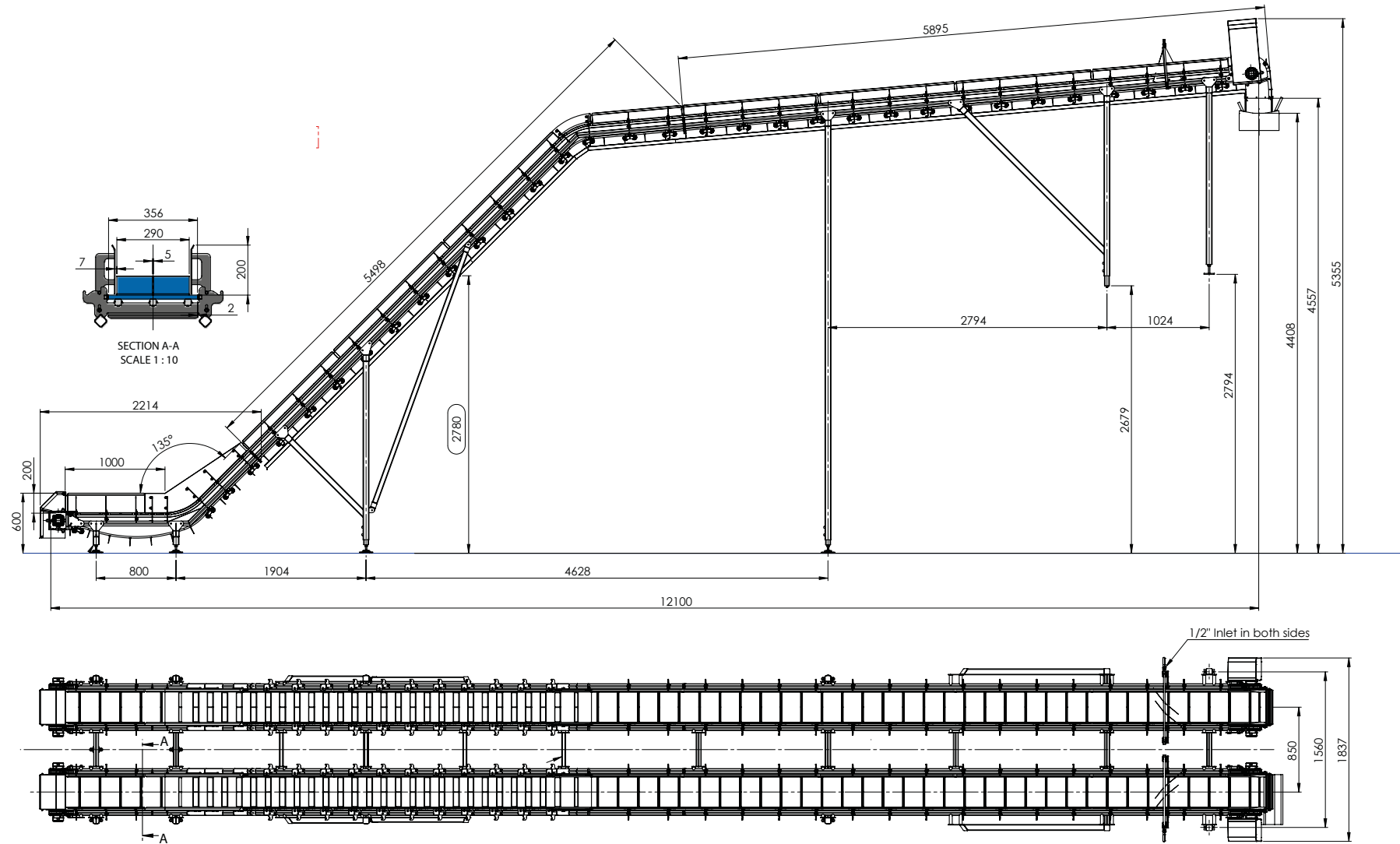

Reversible conveyor for fire doors with 215 mm sides, driven together

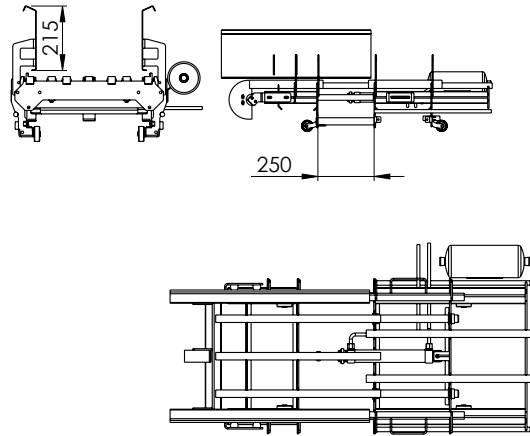

Reversible conveyor for fire doors with 160 mm sides, driven apart

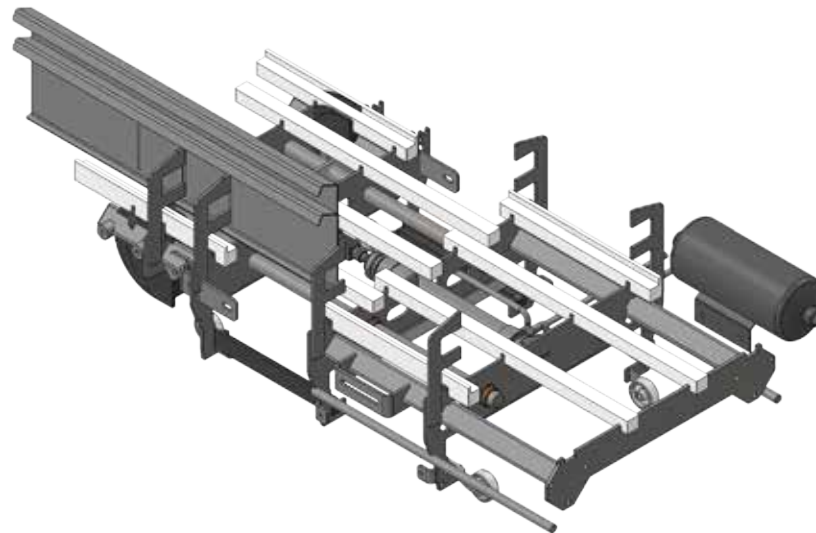
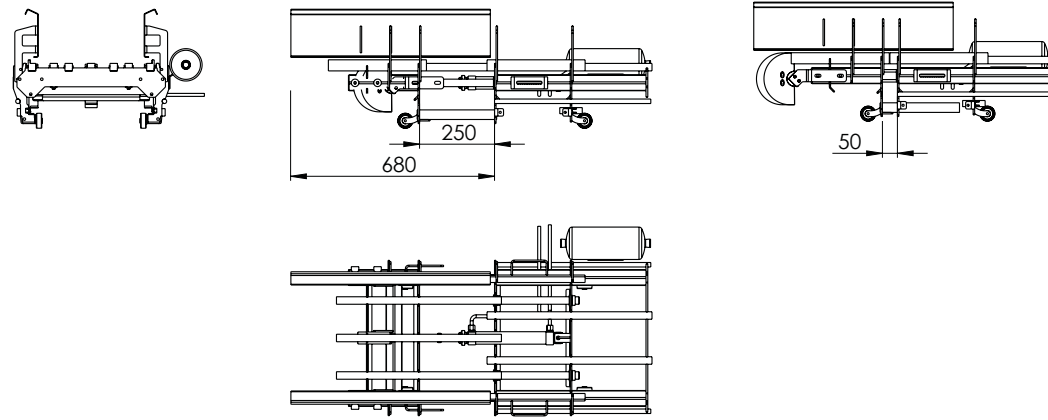

2M Carnitech | 1/4 spiral curve conveyor

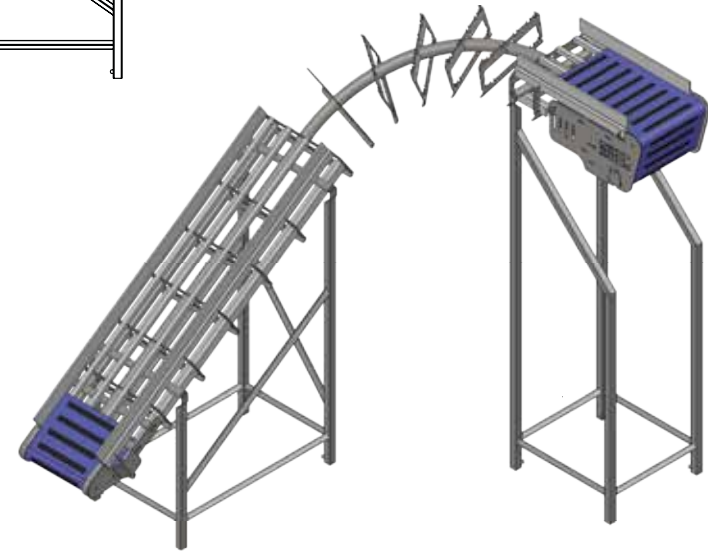
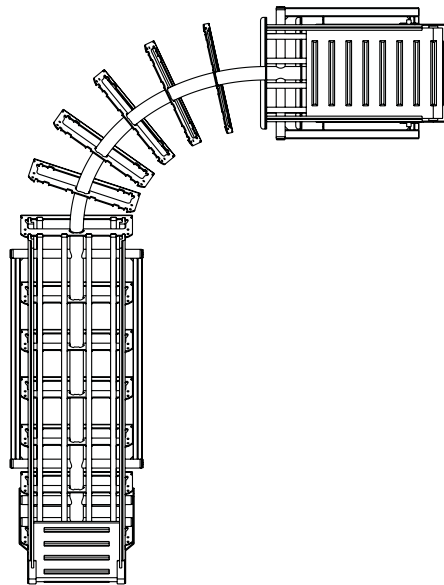
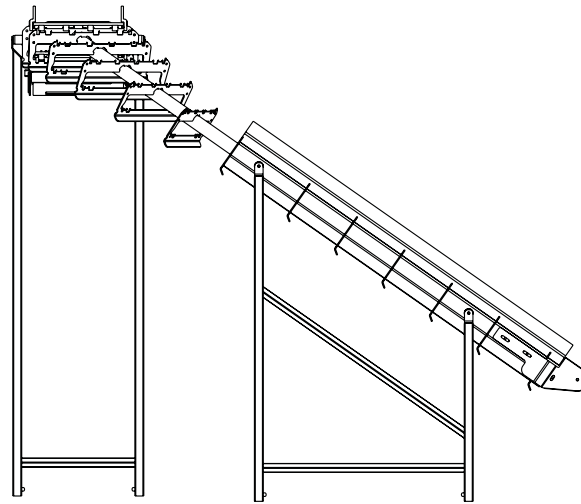
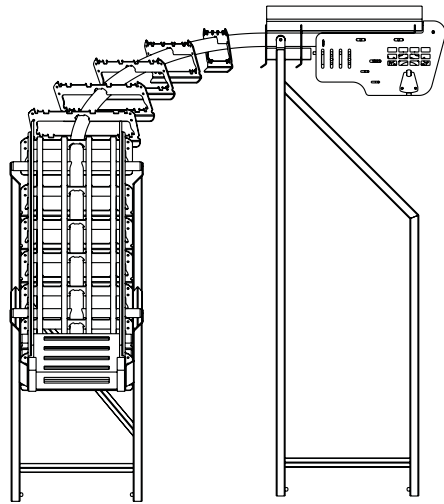

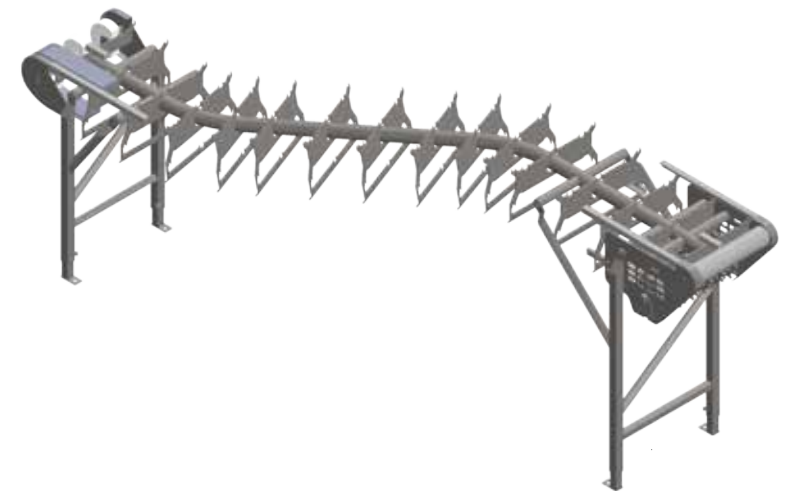
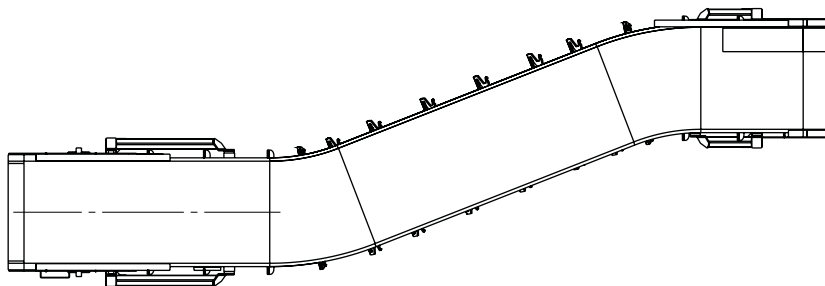
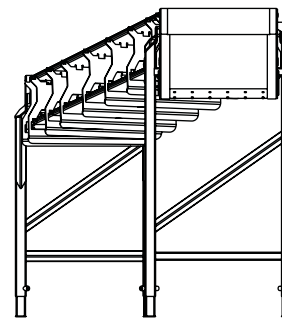
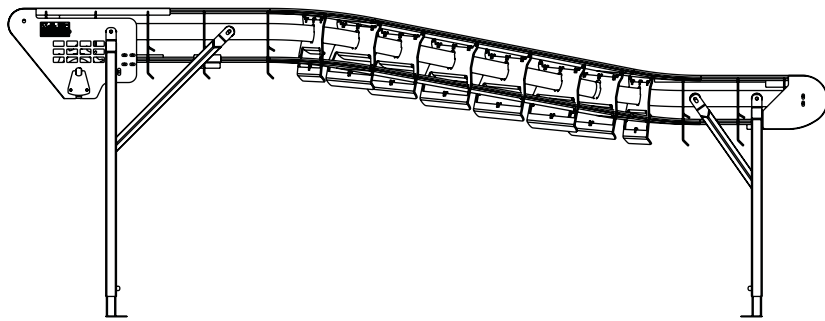

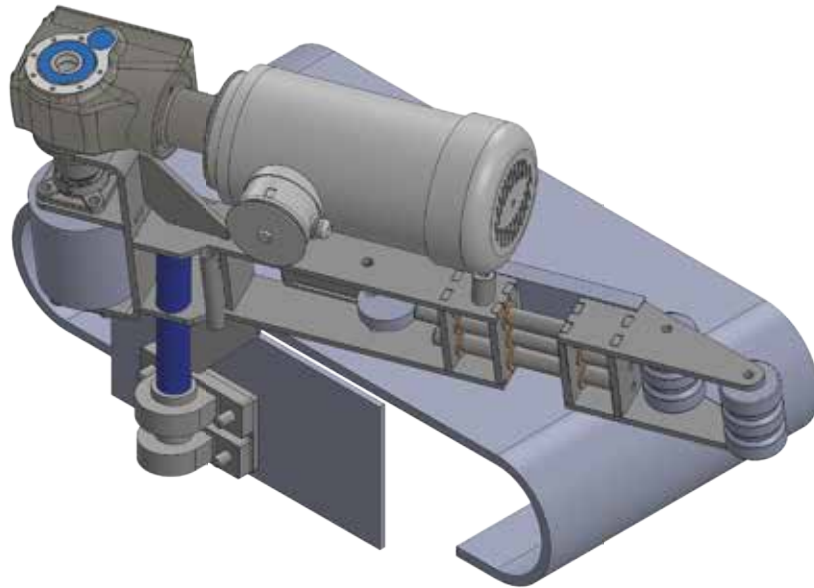
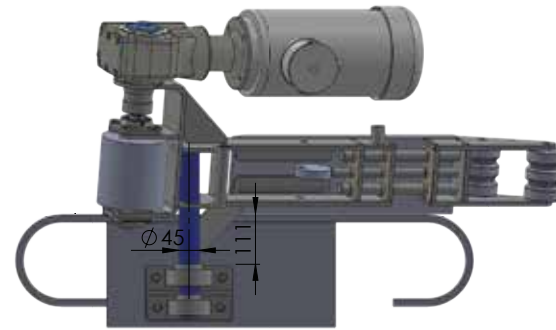
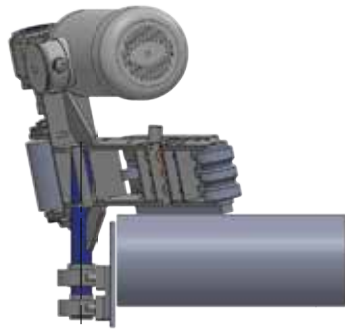

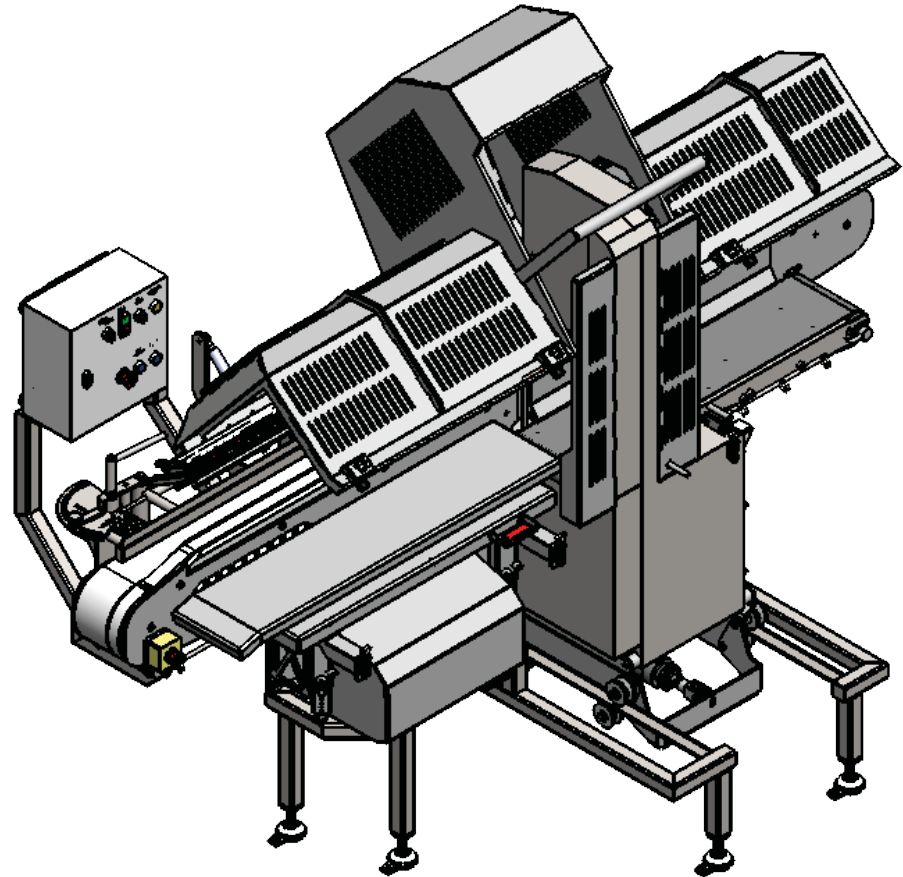
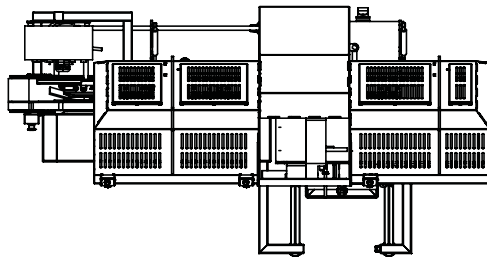
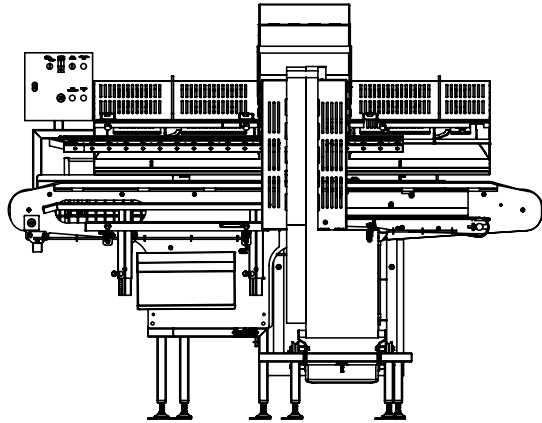
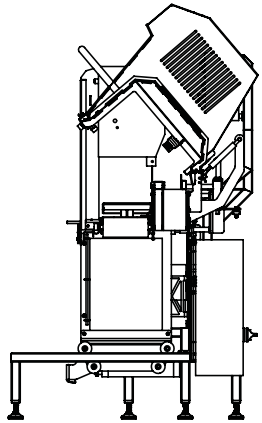

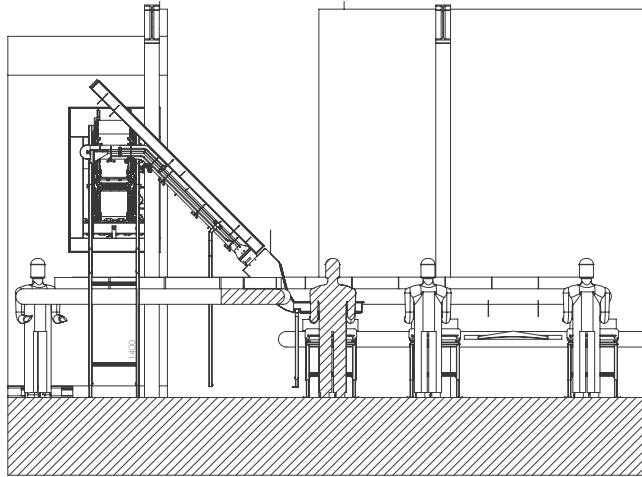

SECTION a-b  
SCALE 1 : 25

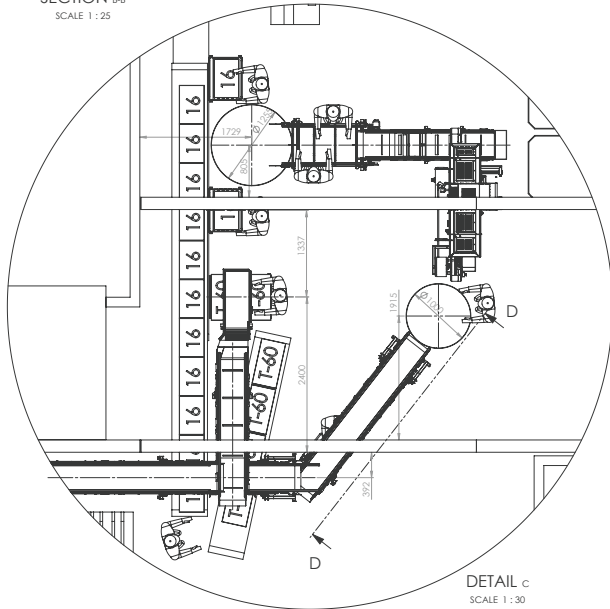

DETAIL c  
SCALE 1 : 30

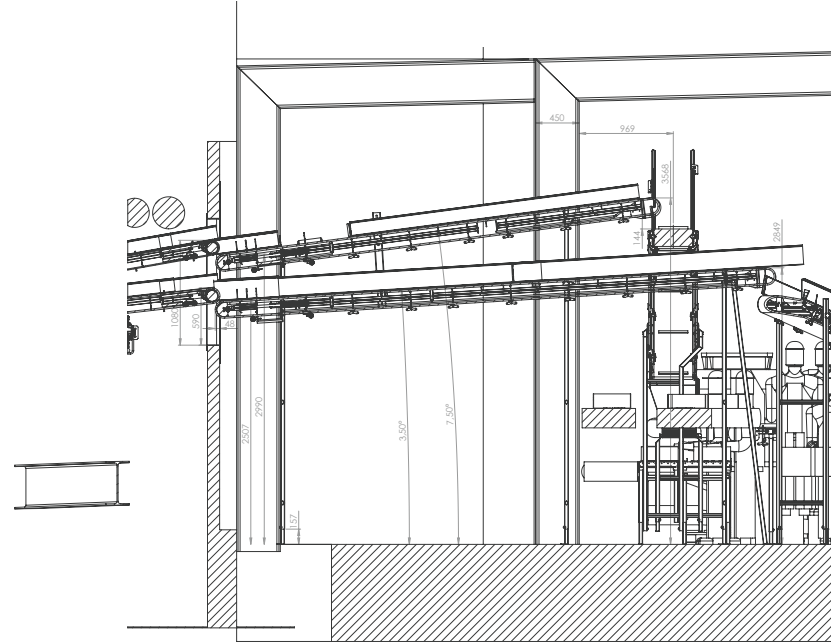

SECTION A-A  
SCALE 1 : 20

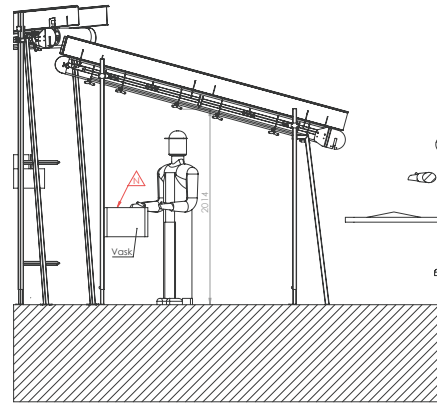

SECTION D-D  
SCALE 1 : 20

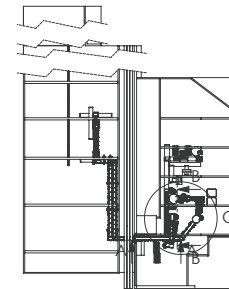



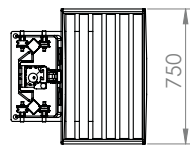
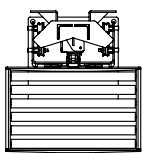
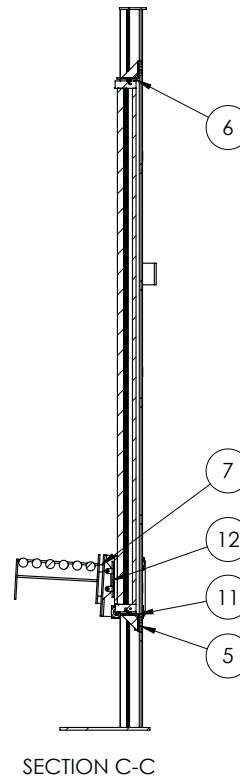
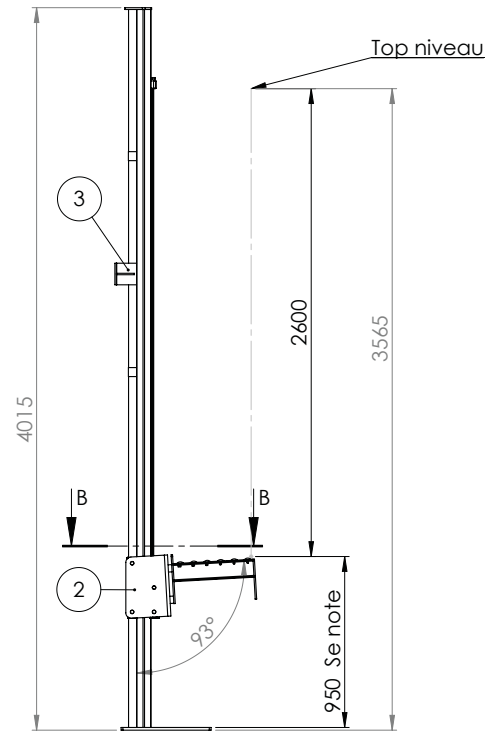
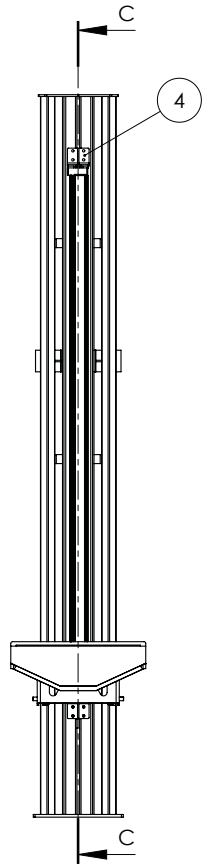

SECTION B-B

Adjustable

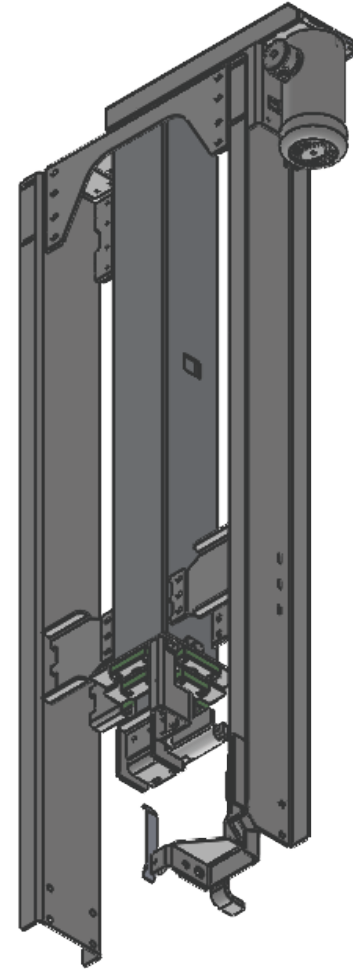
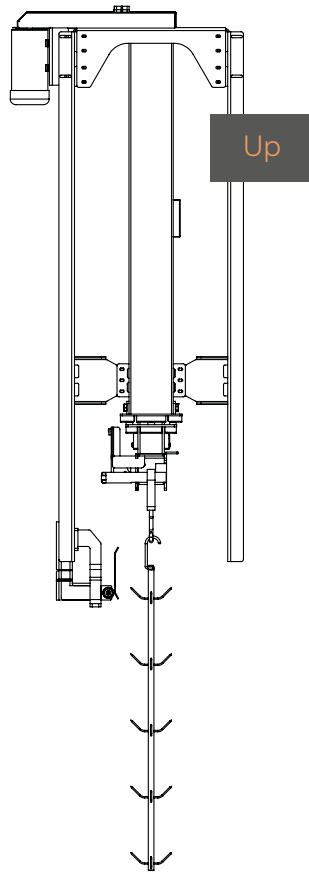
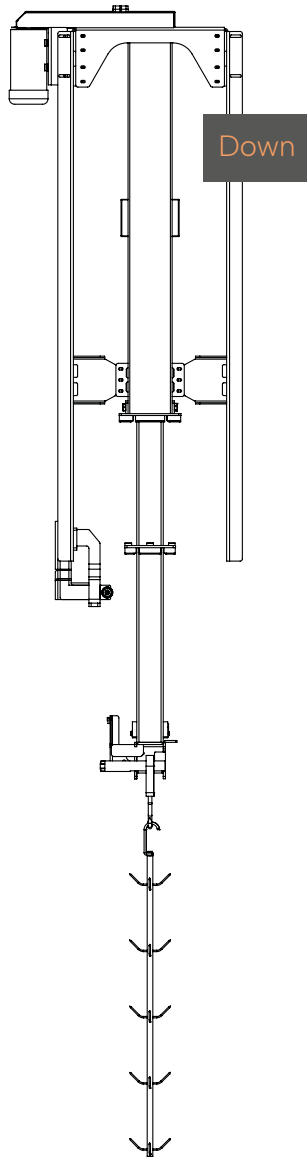

2M Carnitech | Pusher for pigs to scorching oven

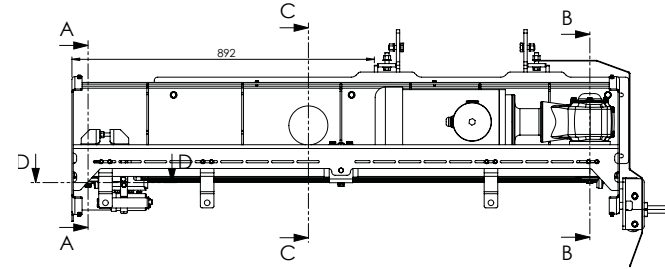

Bagside

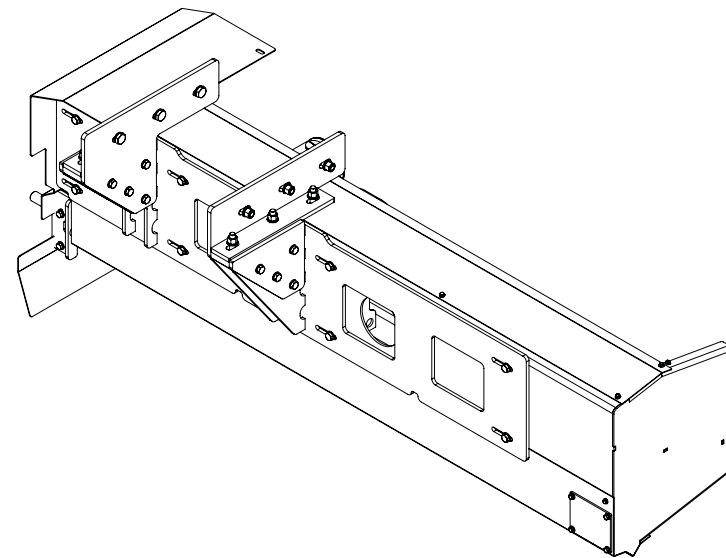
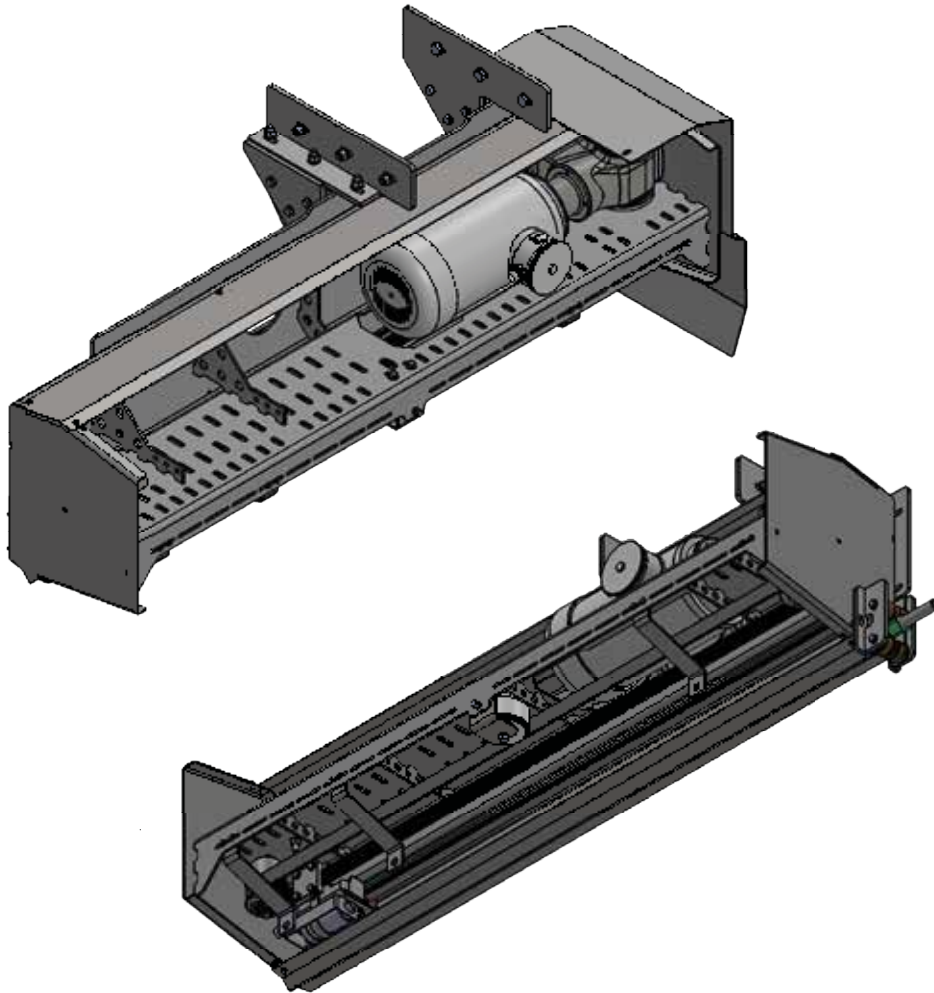
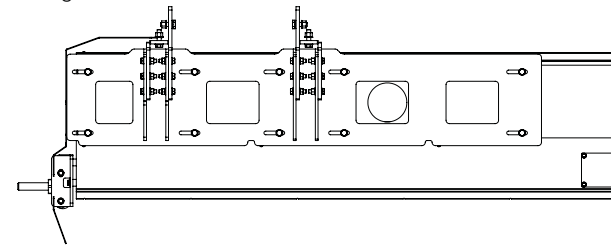

2M Carnitech | Knife sterilizer

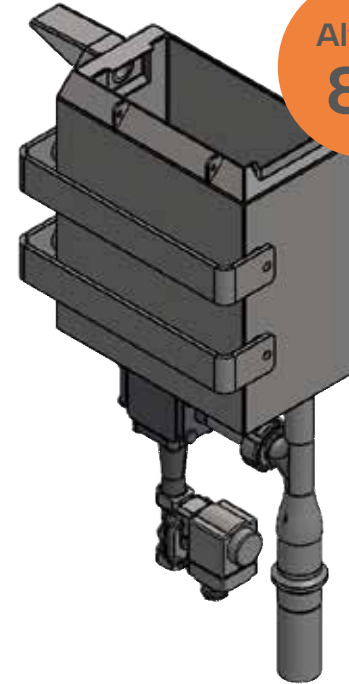
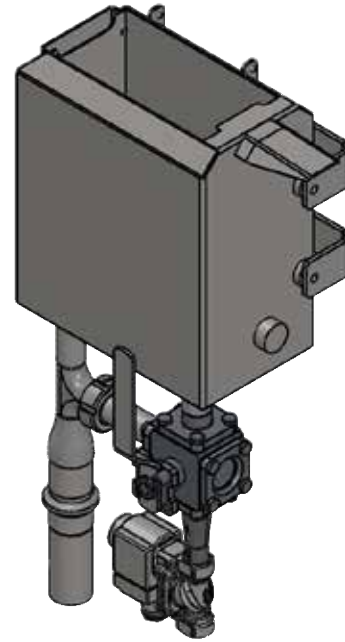
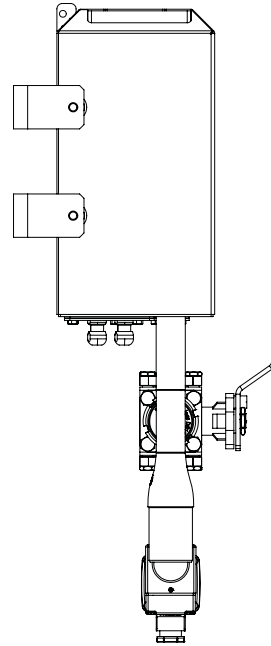
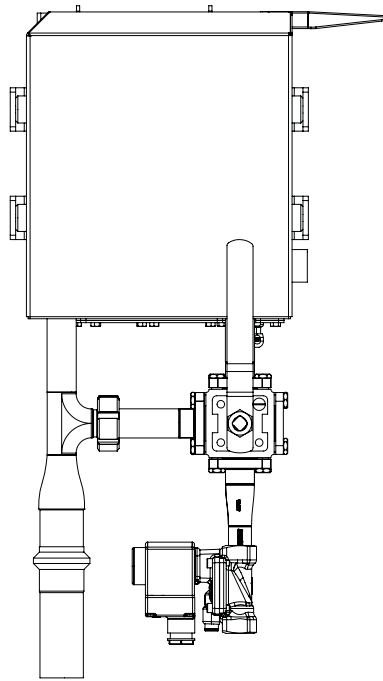

Always  
**82°**

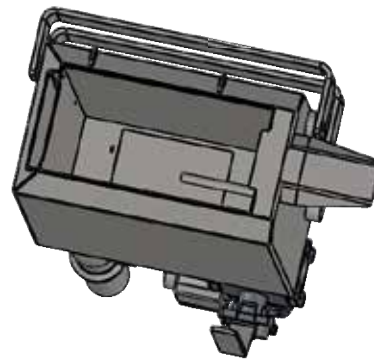
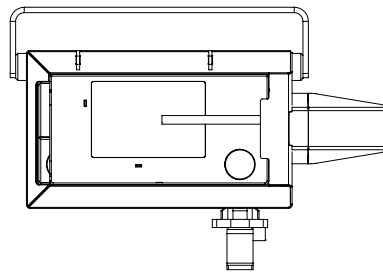

# 2M Carnitech | Lifting device for foil rolls

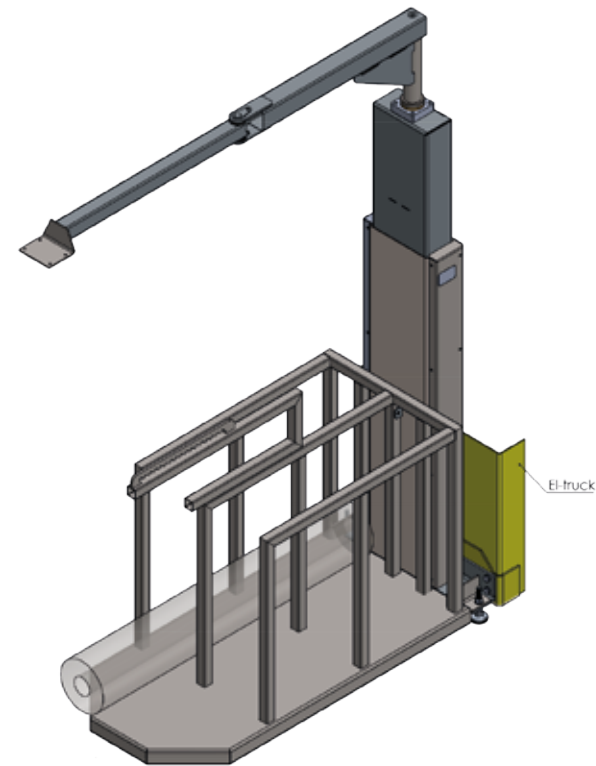
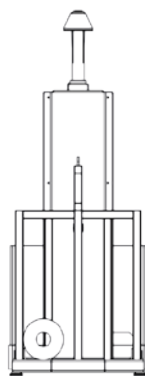
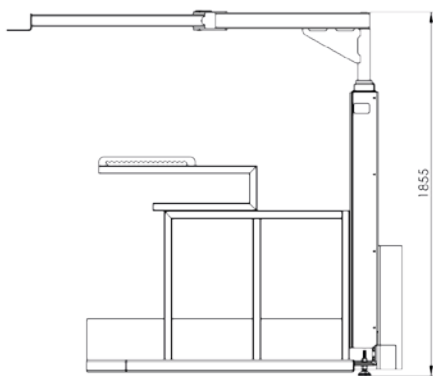
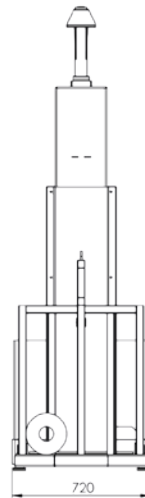
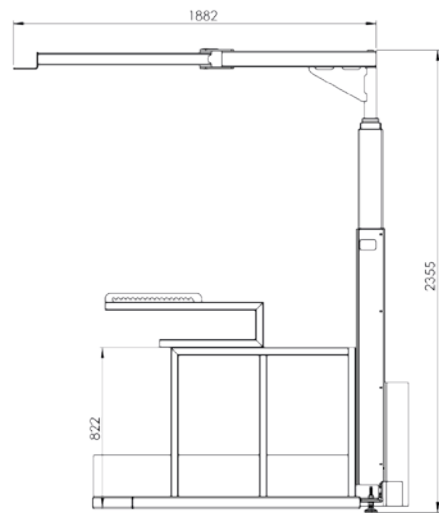



We believe in  
quality and reliability



**2M Carnitech**  
Industrivej 40  
DK-9440 Aabybro  
CVR. 40 75 21 02

+45 96 96 18 18  
info@2mcarnitech.dk  
www.2mcarnitech.dk